

# YAMAHA Grizzly 700

2016 r.

Material: Aluminium

## Main parts of skid plate set

Part name	Part number	Fitting
Main part	40.3900	2x Bolt M8x20 2x Bolt M10x25
		23x Screw M8x20 2x Bolt M8x25
		11x Bolt M8x30 2x Nut M8
		40x Washer 8 34x Washer 8Г
		2x Washer 10 2x Washer 10Г
		2x SD 28000 2x Absorber medium
		1) 2x Bracket
		2) 1x Clamp
		3) 1x Bracket
		4) 1x Bracket
		5) 1x Bracket
		6) 2x Bracket
		7) 2x Bracket
		8) 2x Bracket
		9) 4x SD 3007
		10) 2x Bracket
		11) 2x SD 3008
		12) 2x Wing

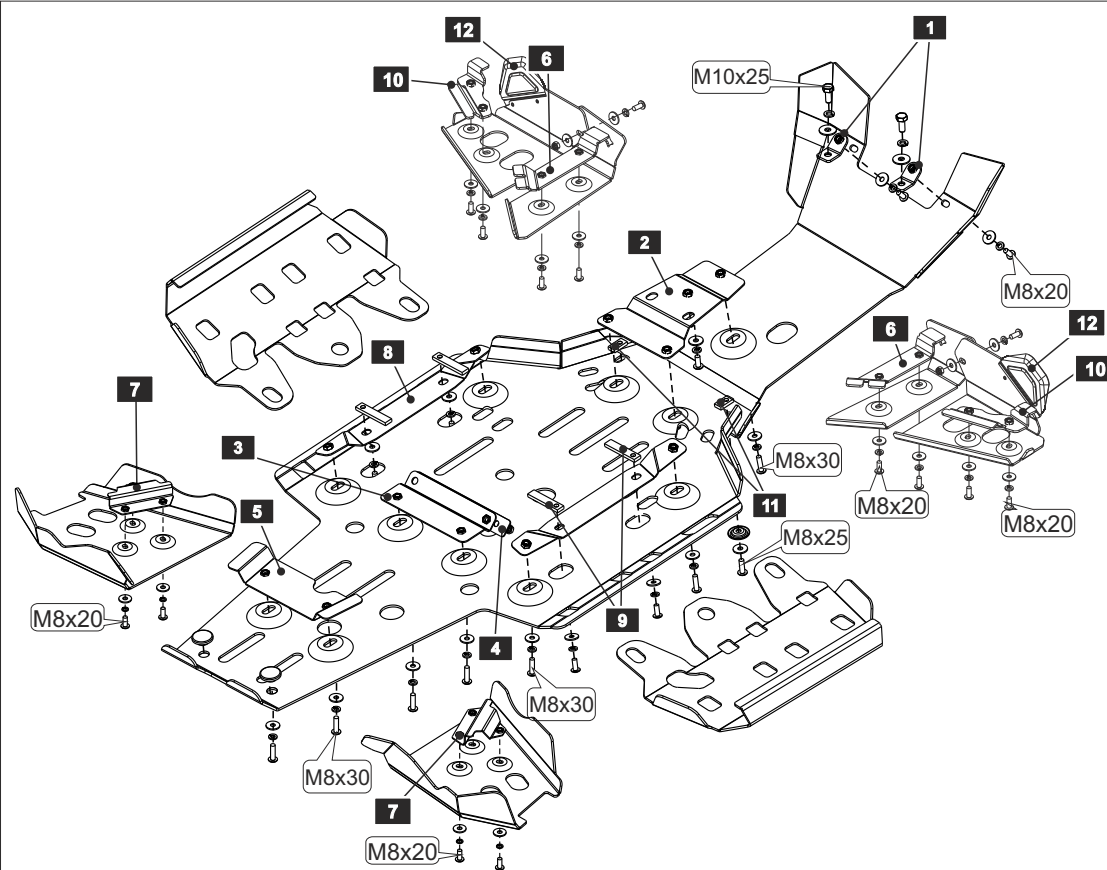
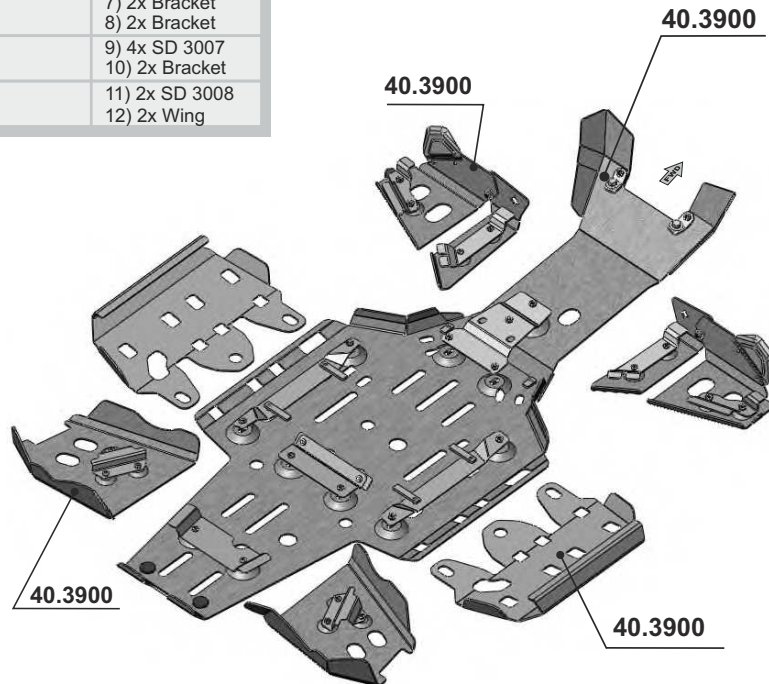
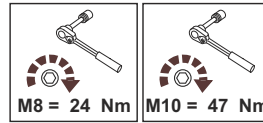

## Yamaha Grizzly 700 2016r Installing the skid plate.

1. Remove a regular plastic protection.
2. Install the brackets "1" at the regular places of mounting the winch as shown on the scheme. If the front subframe of the ATV mounted winch, regular bolts the winch must be replaced by bolts M10x25, and then install the brackets as shown on the scheme.
3. Install the clamp "2" on welded frame element of the ATV, fix the clamp bolt M8x20.
4. Fix a bracket "3" on the transverse edge of the frame of the ATV as shown on the scheme, using the strap "4" and bolts M8x20.
5. Install strap "5" in the appropriate place in the frame of the ATV as shown on the scheme.
6. Install the brackets "8" on the frame of the ATV using threaded inserts "9" and the bolts M8x20. The bolts not tighten. Position of the straps be adjusted relative to the mounting holes.
7. Install bracket "6","7","10" in suitable locations of front and rear levers of the ATV as shown on the scheme.
8. Install the front and rear parts of the skid plate on the mounting points using the fasteners as shown on the scheme. The mounting bolts of the rear part to tighten one or two turns, fastening the rear side parts not to install.
9. Install the side steps protection as shown on the scheme, so that the inner protrusions of the side steps protection is caught between the frame of the ATV and skid plate, and the outer limb of the protection lay on the plastic side steps of the ATV. Adjust the position of the threaded inserts "9" relative to the mounting holes, install the bolts M8x30.
10. Adjust the relative position of the retaining holes through which pulled together the two parts of the skid plate. Install the bracket "11" over the mounting holes, with the fastening bolts as shown on the scheme.
11. For fitting fasteners of the protection of the bottom.
12. Install the A-arms protection on the created mounting points front and rear arms, using the fastener as shown on the scheme. Center A-arms protection, tighten the fasteners.

**STORM**

www.stormprotect.ru; www.storm-protect.com

**STORM**

www.stormprotect.ru; www.storm-protect.com