

Can-Am Outlander

Material: Aluminium

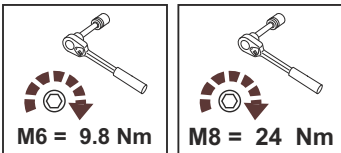

Main parts of skid plate set

Part name	Part number	Fitting
Main part	40.3248	14 x Bolt M8x20 2 x Screw M6x20
		36 x Screw M8x20 2 x Screw M8x35
		2 x Screw M8x40 6 x Nut M6
		6 x Absorber medium
		4 x Washer 6 2 x Washer 6Г
		30 x Washer 8 30 x Washer 8G
		24 x SD 28000 1) 4 x Bracket
		2) 2 x Bracket 3) 2 x Bracket
		4) 12 x SD 3008 5) 1 x Rear bracket
		6) 2 x SD 3007 7) 1 x Bracket
		8) 1 x Clamp 10) 2 x Clamp
		11) 2 x Bracket 12) 1 x Clamp
		13) 6x Hook 14) 2x Slat

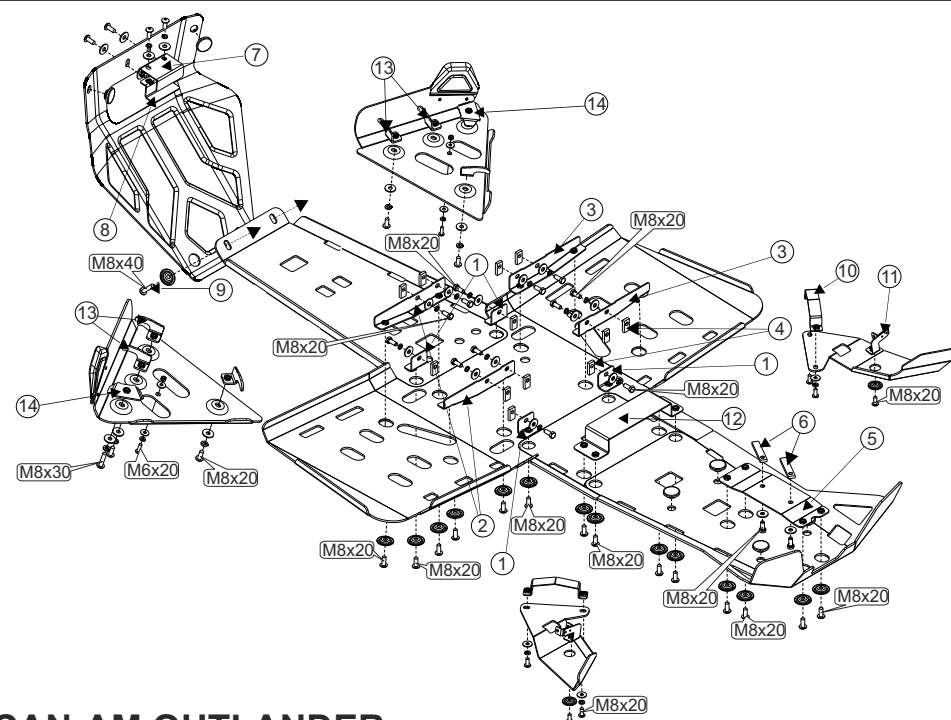
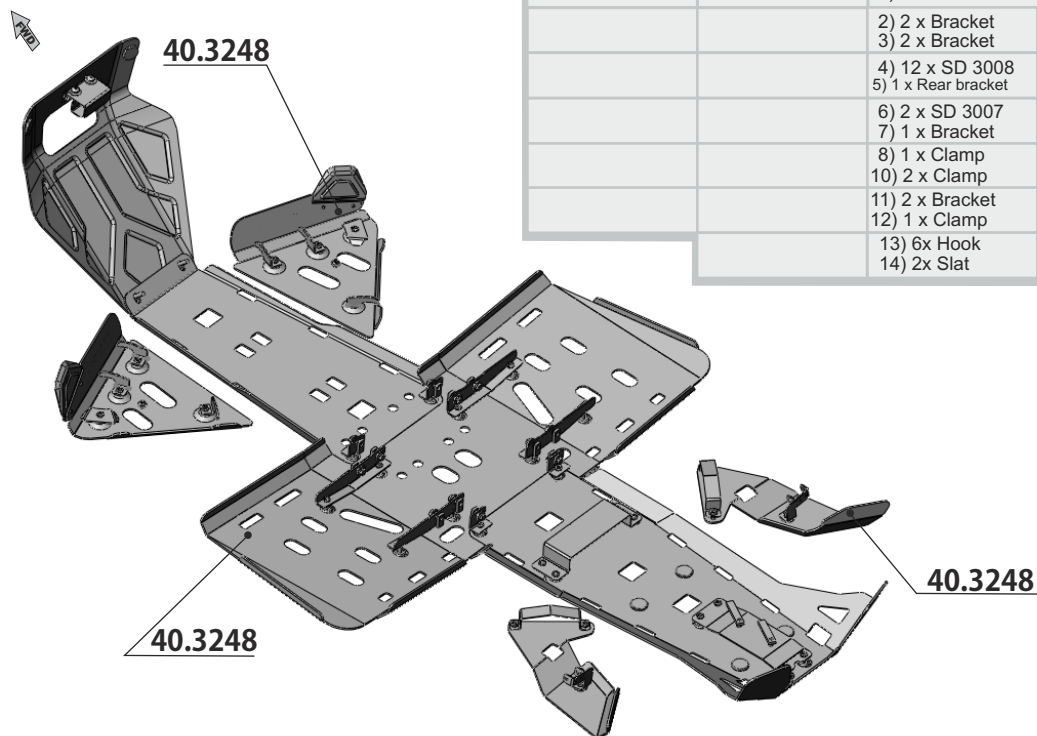

CAN-AM OUTLANDER. Installing the skid plate

1. Remove from ATV regular plastic duster (to get pinched front ledge protection plastic should loosen the bolts that attach the frame of the ATV subframe with winch, after which the subframe needs a little press forward).
2. Install the brackets POS. 1,2,3 on the frame of the ATV as shown on the scheme. It is desirable not to remove all regular the nuts, tightening the sides of the brackets side steps of the ATV. When installing the brackets POS. 1, and also (partially) brackets 2 and 3 it is possible to replace a regular fasteners on the bolts with straps POS. 4, which as shown on the scheme.
3. Install the bracket 5 using straps 6 as shown on the scheme (straps should be placed on top of the weld of the protective element of the frame of the ATV over the two holes corresponding mounting holes of the bracket, then fasten the bracket holding the straps).
4. Install a cross tube that is part of the subframe with winch, bracket 7 with the clamp 8 as shown on the scheme. The screws, tightening bracket and a bracket, not tighten, that facilitate the installation of the skid plate.
5. Put clamp POS.12 on top of the frame of the ATV as shown on the scheme.
6. Install the skid plate on the created mounting points using the fasteners that are as shown on the scheme (screws POS.9 are used with standard nuts). Center skid plate, tighten fasteners, for fitting the screws, tightening bracket 7 and clamp 8.
7. Fix the front arms of the skid plate with screw M6 nut (screw securely positioned front arms of the skid plate in the correct position), then install the hooks with the appropriate screws and washers and the slats 14 with screw M8x35 as shown on the scheme.
8. Install brackets 11 using regular bolts that secure the plastic duster of the rear levers. Install the brackets as shown on the scheme. Install the clamps 10 on top of the rear levers. Install the rear arms of the skid plate on the created mounting points. Tighten the fasteners.

STORM

www.stormprotect.ru; www.storm-protect.com

STORM

www.stormprotect.ru; www.storm-protect.com